



PennEngineering
Corporate Headquarters – Danboro, PA
 5190 Old Easton Rd.
 Danboro, PA 18916
Phone: 215-766-8853
Toll-Free Phone: 1-800-237-4736 (U.S. only)
Email: info@pemnet.com
Website: www.pemnet.com

Part # T4-10-025, TYPE T4™ microPEM® TackPin® Fasteners

New self-clinching microPEM® TackPin® (Type T4™)fasteners are ideal for installation into stainless steel and higher strength aluminum alloy sheets. They are for use in compact electronic assemblies enabling sheet-to-sheet attachment, replacing costly screw installation in applications wheredisassembly is not required. TackPin® fasteners eliminate typical screw-relatedissues (including tapping, cross-threading, torque control, and vibration backout)and ultimately promotes quick and easy

[+ more](#)

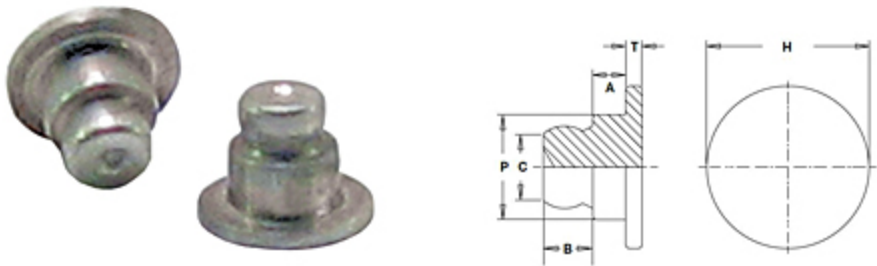

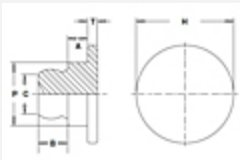
Specifications		
Fastener Material	Hardened 400 Series	Stainless Steel
Base Panel Hole Size Code	10	
Top Sheet Thickness Code	025	
Top Sheet Thickness	0.2 to 0.28 mm	.008 to .011 in
Base Panel Min. Sheet Thickness ¹	0.89 mm .035 in	
Top Sheet Hole Size ± 0.05mm/± .002in	1.47 mm	.058 in
Base Panel Hole Size -0.05mm/ -.002in	1.02 mm .040 in	
	0.406 mm	.016 in
A ± 0.025mm/±.001in		
B ± 0.075mm/±.003in	0.610 mm .024 in	

C Max.	0.89 mm	.035 in
H ± 0.1mm/±.004in	2 mm .079 in	
P ± 0.05mm/±.002in	1.3 mm	.051 in
T ± 0.1mm/±.004in	0.2 mm .008 in	
Min. Dist. Hole C/L to Edge	1 mm	.039 in
Standard Finish	Passivated and/or tested per ASTM A380	
For Use in Sheet Hardness	HRB 88 or Less (Hardness Rockwell “B” Scale)	HB 183 or Less (Hardness Brinell)
CAD Supplier	PennEngineering® (PEM®)	

¹ 0.89 mm/.035 in for blind holes and 0.5 mm/.020 in for thru holes.